



## SMA-SMA adapters (DC~27GHz)

### Specifications

Impedance: 50Ω
Frequency: DC-27GHz
Durability: 500 cycles
Temperature Range: -55°C~+165°C

### Material/Finishing

Housing: Stainless steel SU303	Polished/Passivated
Center contact: Beryllium Copper	Gold plated (MIL-G-45204)
Insulators: PEI&PTFE	

### SMA Interfaces PER MIL-STD-348A

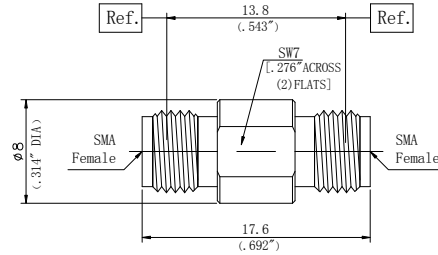

Description	SMA (f) to SMA (f)
PN	Z555500Z01
VSWR	DC-27GHz ... 1.15:1 (max)

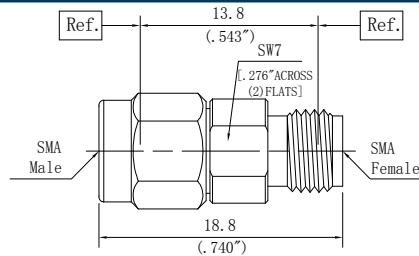
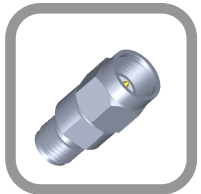

Description	SMA (m) to SMA (f)
PN	Z555510Z01
VSWR	DC-27GHz ... 1.15:1 (max)

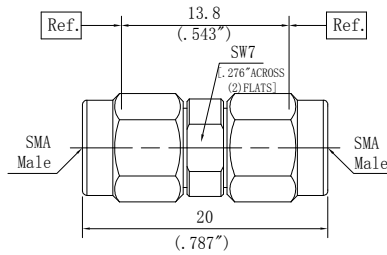

Description	SMA (m) to SMA (m)
PN	Z555511Z01
VSWR	DC-27GHz ... 1.15:1 (max)

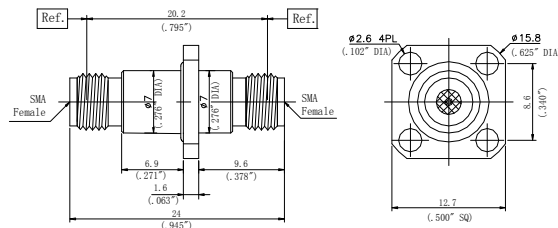
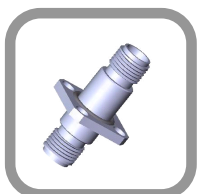

Description	SMA (f) to SMA (f)
PN	Z555500FS01A
VSWR	DC-27GHz ... 1.15:1 (max)

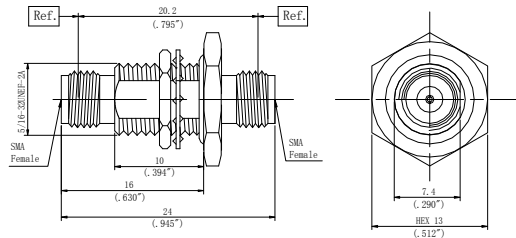
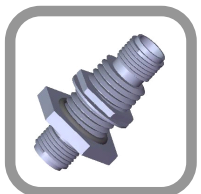

Description	SMA (f) to SMA (f)
PN	Z555500YS02
VSWR	DC-27GHz ... 1.15:1 (max)