



2.4mm-SMA adapters(DC~27GHz)

Specifications

Impedance:	50Ω
Frequency:	DC-27GHz
Durability:	500 cycles
Temperature Range:	-55°C~+165°C

Material/Finishing

Housing:	Stainless Steel SU303	Polished/Passivated
Center contact:	Beryllium Copper	Gold plated(MIL-G-45204)
Insulators:	PEI	

2.4mm interfaces PER IEEE STD 287-2007 SMA interfaces PER MIL-STD-348A

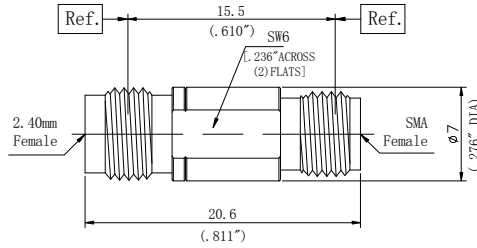
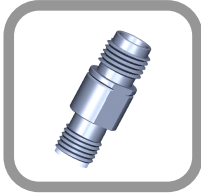

Description	2.4mm (f) to SMA (f)
PN	Z375500Z01
VSWR	DC-27GHz . . .1.15:1 (max)

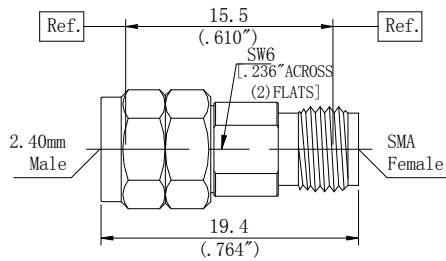

Description	2.4mm (m) to SMA (f)
PN	Z375510Z01
VSWR	DC-27GHz . . .1.15:1 (max)

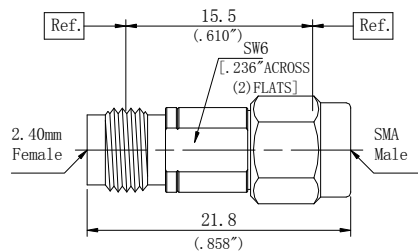

Description	2.4mm (f) to SMA (m)
PN	Z375501Z01
VSWR	DC-27GHz . . .1.15:1 (max)

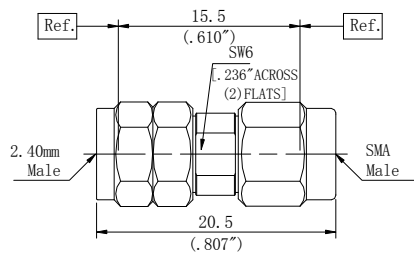

Description	2.4mm (m) to SMA (m)
PN	Z375511Z01
VSWR	DC-27GHz . . .1.15:1 (max)